

Brass Bulkhead Adaptor

Connects metric pipe connections that are made through walls or partitions.

Overview

John Guest brass bulkhead adaptor push-fit fitting for the connections of metric pipe or tubing in through-wall applications. Fast and simple to install, John Guest Air and Pneumatics creates an instant connection and airtight seal without the need for tools, hot works or sealing agents. Air piping systems can be set up and installed 50% quicker than traditional methods.

The unique collet locking design firmly and securely holds the pipe in place without deforming the pipe or restricting flow. Fittings are also fully demountable, reducing system downtime during maintenance and making it quick and easy to modify or extend systems.

Designed in brass, fittings are compatible with John Guest nylon, powder coated aluminium or LLDPE tubing, as well as copper, PEXa and other soft metal pipe materials. All John Guest fittings are manufactured and assembled in the UK.

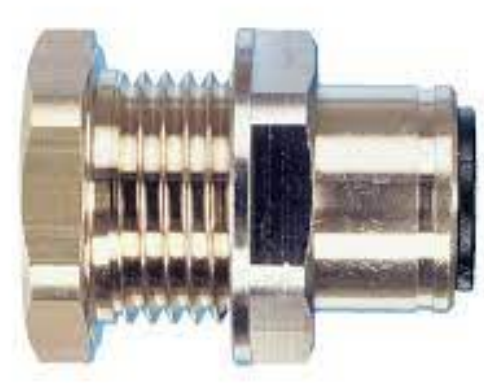

Features & Benefits

- Brass fitting with nitrile O-Ring
- Airtight connection with superior flow characteristics
- Instant push-fit connection and demountable without tools
- Secure collet cover prevents accidental disconnection
- Suitable for air and pneumatics piping systems up to 10 bar
- Ideal for air, inert gases and vacuum applications
- Food grade fitting suitable for potable liquids
- Compatible with soft metal or plastic pipe/tubing

Product code	Description	Size	Bag QTY
RM070612	Bulkhead Connector	6mm	10
RM070812	Bulkhead Connector	8mm	10



Brass Bulkhead Adaptor

Working parameters & specifications

Application	Maximum working pressure, bar
Air	16 Bar

Materials	
Body	Brass
O-Ring	Nitrile, Black
Collet	Acetal Copolymer (Unfilled), Black
Collet Teeth	Stainless Steel 301

Dimensions – All measurements in mm unless otherwise stated

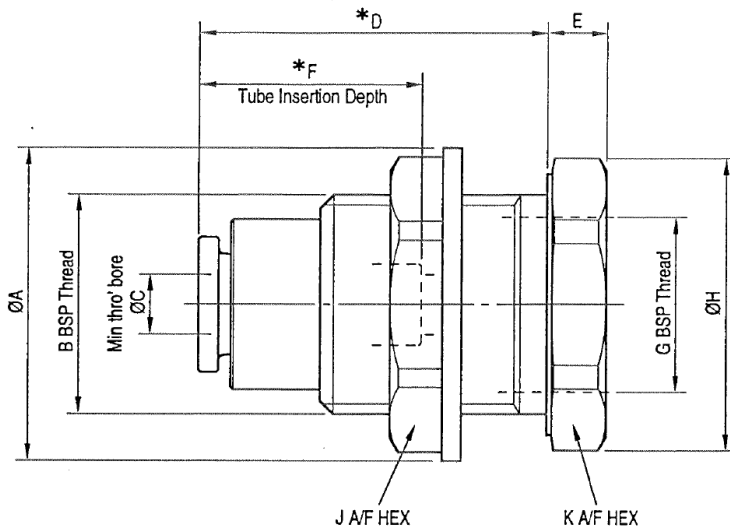

* With collet in fully released position

Bulkhead Adaptors												
Product No.	Description	Tube O/D	ØA	B BSP	ØC	*D	E	*F	G BSP x DPTH	ØH	J	K
RM070411N RM070411	4mm x 1/8 BSP	4.0	19.0	1/4 BSP	3.0	21.8	4.2	14.3	1/8 BSP x 7.8	17.5	16.0	16.0
RM070511N RM070511	5mm x 1/8 BSP	5.0	19.0	1/4 BSP	4.0	21.8	4.2	14.3	1/8 BSP x 7.8	17.5	16.0	16.0
RM070612N RM070612	6mm x 1/4 BSP	6.0	23.0	3/8 BSP	4.5	25.4	4.6	15.8	1/4 BSP x 10.3	22.0	20.0	20.0
RM070812N RM070812	8mm x 1/4 BSP	8.0	23.0	3/8 BSP	6.0	26.5	4.6	16.8	1/4 BSP x 10.3	22.0	20.0	20.0
RM071013N RM071013	10mm x 3/8 BSP	10.0	28.0	1/2 BSP	8.0	30.4	5.4	19.9	3/8 BSP x 12.0	27.3	25.0	25.0
RM071214N RM071214	12mm x 1/2 BSP	12.0	38.0	3/4 BSP	10.0	39.4	5.4	25.9	1/2 BSP x 15.0	30.5	32.0	28.0