

Equal Elbow Metric

Connects 2 pipes of equal pipe/tube size to form a 90°

Overview

John Guest equal elbow push-fit fitting connects two equally sized pipes or tubes to form a 90° pipe bend. Fast and simple to install, John Guest Air and Pneumatics creates an instant connection and airtight seal without the need for tools, hot works or sealing agents. Air piping systems can be set up and installed 50% quicker than traditional methods.

The unique collet locking design firmly and securely holds the pipe in place without deforming the pipe or restricting flow. Fittings are also fully demountable, reducing system downtime during maintenance and making it quick and easy to modify or extend systems.

Designed in tough engineered plastic, fittings are compatible with John Guest nylon, powder coated aluminium or LLDPE tubing, as well as copper, PEXa and other soft metal pipe materials. All John Guest fittings are manufactured and assembled in the UK.

Features & Benefits

- Strong acetal copolymer fitting with nitrile O-Ring
- Airtight connection with superior flow characteristics
- Instant push-fit connection and demountable without tools
- Secure collet cover prevents accidental disconnection
- Suitable for air and pneumatics piping systems up to 10 bar
- Ideal for air, inert gases and vacuum applications
- Food grade fitting suitable for potable liquids
- Compatible with soft metal or plastic pipe/tubing



Product code	Description	Size	Bag QTY
RM0304E	Equal Elbow	4mm	10
RM0305E	Equal Elbow	5mm	10
RM0306E	Equal Elbow	6mm	10
RM0308E	Equal Elbow	8mm	10
RM0310E	Equal Elbow	10mm	10
RM0312E	Equal Elbow	12mm	10



Equal Elbow Metric

Working parameters & specifications

Application	Maximum working pressure, bar
Air	16 Bar (4-8mm) / 10 Bar (8-28mm)

Materials	
Body	Acetal Copolymer (Unfilled), Black
O-Ring	Nitrile, Black
Collet	Acetal Copolymer (Unfilled), Black
Collet Teeth	Stainless Steel 301

Dimensions – All measurements in mm unless otherwise stated

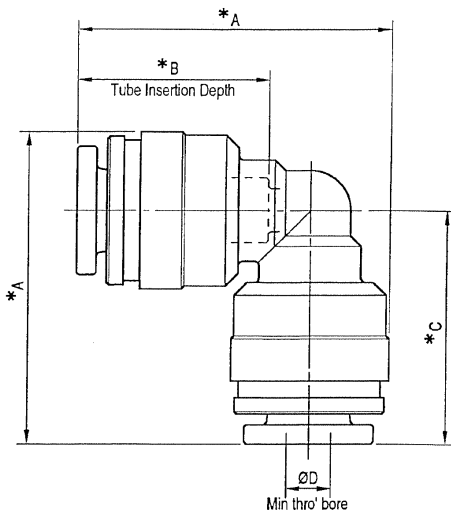

* With collet in fully released position

Equal Elbow Connectors					
Product No.	Tube O/D	*A	*B	*C	ØD
RM0304E	4.0	23.7	14.3	17.5	3.4
RM0305E	5.0	23.7	14.3	17.5	3.4
RM0306E	6.0	26.3	15.8	19.3	4.8
RM0308E	8.0	29.1	16.9	21.1	6.4
RM0310E	10.0	35.1	19.9	25.4	7.6
RM0312E	12.0	43.7	25.9	32.5	8.7

Dimensions in mm unless stated otherwise